

PRO-76 | INDUSTRIAL DRILLING MACHINE

PRO 76 is the newest multifunction drill with Morse Taper No. 3



Superior features of PRO76 include:









- purpose designed motor with heavy duty gear box
- electronic speed control
- electronic speed stabilization system
- maintenance friendly design
- gear box and slide system made as one piece
- maintenance friendly rail guide system

It is equipped with motor overload protection system, electronic speed control, Electronic Speed Stabilization System (ESSS) – responsible for stabilizing motor's speed under varying loads on the spindle. PRO 76 precision and durability are significantly increased thanks to integrated gearbox housing with slide.

Unique semi-automatic gib adjustment system (patent pending) enables simple, fast and always correct fine tuning without any expert knowledge or experience. Replaceable spline at the end of armature shaft eliminates laborious and expensive armature maintenance. Compact design allows for drilling very close to vertical surface.

PRO 76 is also equipped with electromagnetic base featuring magnetic field shape control system (MFSC) and magnetic power adhesion control module (MPAC), which detects adhesive force of electromagnetic base and protects both the machine and the operator from work on too thin workpieces.

Standard shipping set of PRO 76 includes MT3 Arbor with 19 mm (3/4") Weldon Bore that accepts cutters up to 60 mm diameter. Optional MT3 Arbor with 32 mm (1-1/4") Weldon Bore for cutters of larger diameters is available.

| | | | | | | | |
|---|---|---|---|---|--|---|---|
|  |  |  |  |  |  |  |  |
| Core drill max 76 mm | Twist drill max 32 mm | Spindle MT3 | Depth of cut 76 mm | Stroke 225 mm | Speed 80-160, 210-420 rpm | Motor Power 1650 W | Weight 27 kg |



Max
Ø 76 mm
(3")



Max
Ø 32 mm
(1 1/4")



Max
Ø 63 mm
(2 1/2")



Max
M 24

PRO 76 - TECHNICAL SPECIFICATION

| | |
|----------------------------------|--|
| Motor Speed (under load) | 80±160; 210±420 rpm |
| Motor Power | 1650 W |
| Weight | 27 kg (58 lbs 4 oz) |
| Max milling capacity | Ø 76 mm (3") |
| Max drilling capacity | Ø 32 mm (1-1/4") |
| Max countersinking | Ø 63 mm (2-1/2") |
| Max tap size | M24 (tapping attachment required) |
| Stroke | 225 mm (8-7/8") |
| Max depth of cut | 76 mm (3") |
| Voltage | 1~ 110-120 V, 50-60 Hz 1~ 220-240 V, 50-60 Hz |
| Power consumption | 1800 W |
| Overload protection | yes |
| ESSS | yes |
| Continuous speed adjustment | yes |
| Semi-automatic gib adjustment | yes |
| MPAC | yes |
| MFSC | yes |
| Magnetic clamping force | 1988 kG (19500 N) /25 mm, Ra=1,25/ |
| Magnet Base Dimensions | 110 x 220 x 56 mm 4-5/16 x 8-11/16 x 2-3/16 (") |
| Min. Workpiece Thickness | 10 mm (3/8") |
| Swivel base | ±15°; ±15 mm (± 9/16") |
| Spindle | MT3 |
| Tool holder | 19mm (3/4") or 32mm (1-1/4") Weldon |
| Product Code 220-240 V, 50-60 Hz | WRT-0400-10-20-00-0 |
| Product Code 110-120 V, 50-60 Hz | WRT-0400-10-10-00-0 |

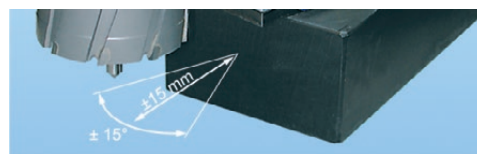

Swivel base in version PRO 76+

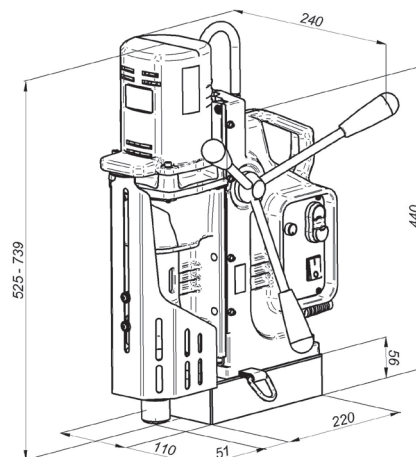

Standard shipping set:

- Magnetic Base Drilling Machine
- Metal Box
- MT3 Arbor with 19 mm Bore - Through Spindle Continuous Cooling
- Swarf Shield/Cutter Guard
- Coolant Bottle Assembly, Safety Chain with Snap Hook, Set of Tools with Wedge
- Operator's Manual (English)
- Standard shipping weight - 40 kg (86 lbs 5 oz)

Selected additional accessories:

- UCW-0191-00-00-00 Through Spindle Continuous Cooling Arbor MT3-32 Weldon Bore
- UCW-0285-03-00-02-0 Quick Change Continuous Cooling Arbor MT3- 19 Weldon
- PDS-0111-03-00-01-0 DMP0501 Pipe Attachment



PROMOTECH Sp. z o.o.
ul. Elewatorska 23/1, 15-620 BIAŁYSTOK, POLAND
tel. (+48 85) 678 34 05, fax (+48 85) 662 78 77
marketing@promotech.eu www.promotech.eu

Your local dealer:

