

PRO 76 | INDUSTRIAL DRILLING MACHINE

PRO 76 is the newest multifunction drill with Morse Taper No. 3

Mitglied im DVS – Deutscher Verband für Schweißen und verwandte Verfahren e. V.

Electronic Speed Stabilization System (ESSS)

Overload Protection

Integrated Gearbox Housing with Slide

Service friendly

Semi-automatic gib adjustment

Motor Soft Start

Continuous Speed Adjustment

Magnetic Power Adhesion Control (MPAC)

Magnetic Field Shape Control (MFSC)

Swivel Base version available



Superior features of PRO76 include:

- purpose designed motor with heavy duty gear box
- electronic speed control
- electronic speed stabilization system
- maintenance friendly design
- gear box and slide system made as one piece
- maintenance friendly rail guide system

It is equipped with motor overload protection system, electronic speed control, Electronic Speed Stabilization System (ESSS) – responsible for stabilizing motor's speed under varying loads on the spindle. PRO 76 precision and durability are significantly increased thanks to integrated gearbox housing with slide.

Unique semi-automatic gib adjustment system (patent pending) enables simple, fast and always correct fine tuning without any expert knowledge or experience. Replaceable spline at the end of armature shaft eliminates laborious and expensive armature maintenance. Compact design allows for drilling very close to vertical surface.

PRO 76 is also equipped with electromagnetic base featuring magnetic field shape control system (MFSC) and magnetic power adhesion control module (MPAC), which detects adhesive force of electromagnetic base and protects both the machine and the operator from work on too thin workpieces.

Standard shipping set of PRO 76 includes MT3 Arbor with 19 mm (3/4") Weldon Bore that accepts cutters up to 60 mm diameter. Optional MT3 Arbor with 32 mm (1-1/4") Weldon Bore for cutters of larger diameters is available.

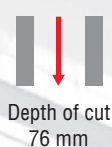



PRO 76 - Technical specification

Motor Speed (under load)	80÷160; 210÷420 rpm
Motor Power	1650 W
Weight	27 kg (58 lbs 4 oz)
Max milling capacity	Ø 76 mm (3'')
Max drilling capacity	Ø 32 mm (1-1/4'')
Max countersinking	Ø 63 mm (2-1/2'')
Max tap size	M24 (tapping attachment required)
Stroke	225 mm (8-7/8'')
Max depth of cut	76 mm (3'')
Voltage	1~ 110–120 V, 50–60 Hz 1~ 220–240 V, 50–60 Hz
Power consumption	1800 W
Overload protection	yes
ESSS	yes
Continuous speed adjustment	yes
Semi-automatic gib adjustment	yes
MPAC	yes
MFSC	yes
Magnetic clamping force	1988 kG (19500 N) /25 mm, Ra=1,25/
Magnet Base Dimensions	110 x 220 x 56 mm 4-5/16 x 8-11/16 x 2-3/16 (")
Min. Workpiece Thickness	10 mm (3/8'')
Swivel base	±15°; ±15 mm (± 9/16'')
Spindle	MT3
Tool holder	19mm (3/4'') or 32mm (1-1/4'') Weldon
Product Code 220–240 V, 50–60 Hz	WRT-0400-10-20-00-0
Product Code 110–120 V, 50–60 Hz	WRT-0400-10-10-00-0



Swivel base in version PRO 76+

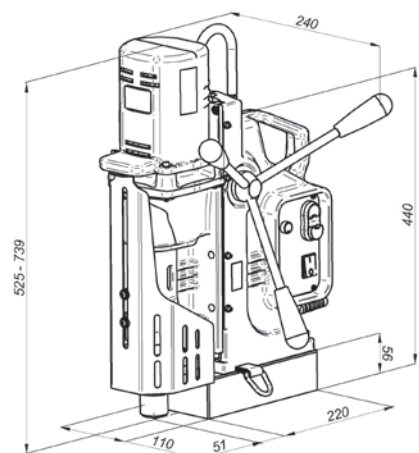

Standard shipping set:

- Magnetic Base Drilling Machine
- Metal Box
- MT3 Arbor with 19 mm Bore - Through Spindle Continuous Cooling
- Swarf Shield/Cutter Guard
- Coolant Bottle Assembly, Safety Chain with Snap Hook, Set of Tools with Wedge
- Operator's Manual (English)
- Standard shipping weight – 40 kg (86 lbs 5 oz)

Selected additional accessories:

- UCW-0191-00-00-00-0 Through Spindle Continuous Cooling Arbor MT3-32 Weldon Bore
- UCW-0285-03-00-02-0 Quick Change Continuous Cooling Arbor MT3- 19 Weldon
- PDS-0111-03-00-01-0 DMP0501 Pipe Attachment

All information is subject to change without notice. 1808



PROMOTECH Sp. z o.o.
ul. Elewatorska 23/1, 15-620 BIAŁYSTOK, POLAND
tel. (+48 85) 678 34 05, fax (+48 85) 662 78 77
marketing@promotech.eu www.promotech.eu

Find us on



Your local dealer:

